

# THE *MINVE*:

The New Home of the Academy  
of the Hebrew Language  
in Jerusalem

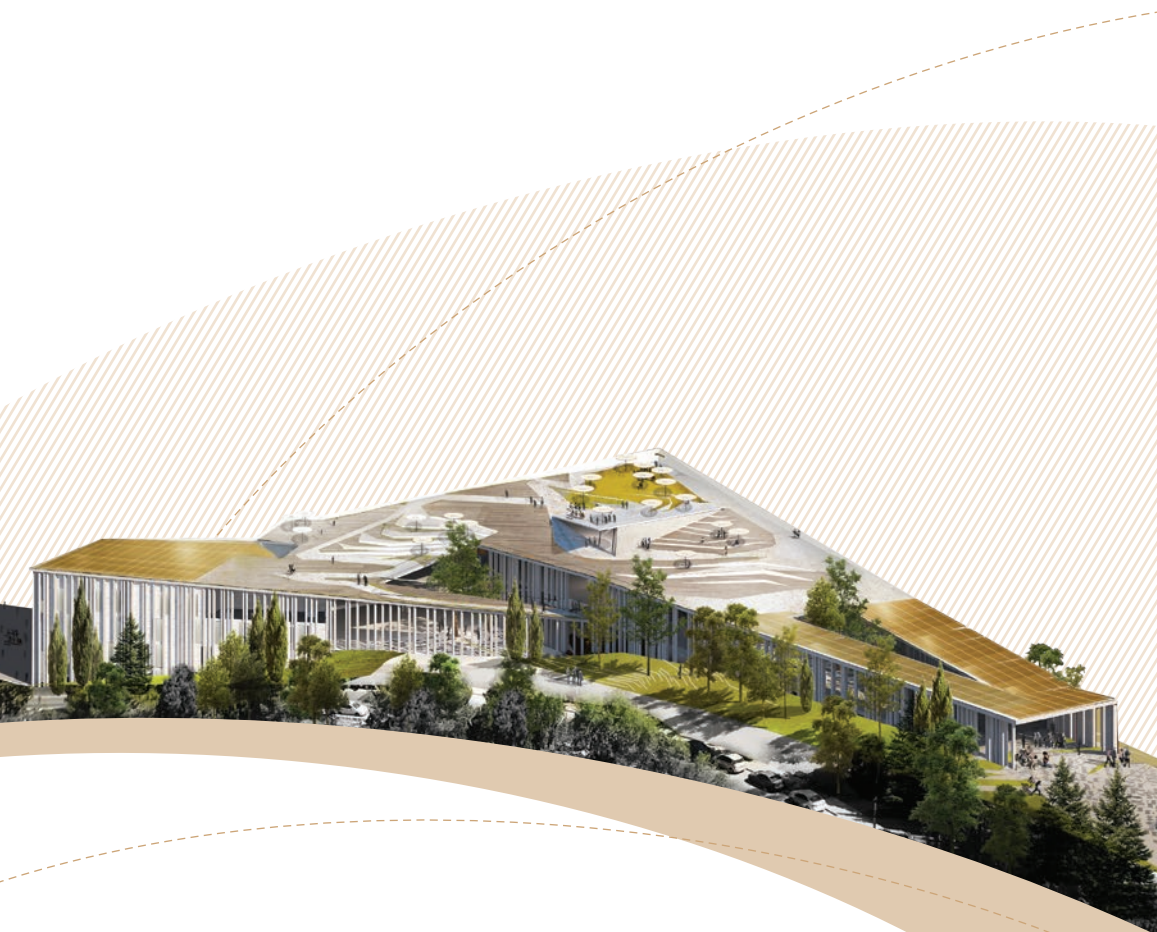

האקדמיה  
ללשון העברית

# “THE HEBREW LANGUAGE

is the cultural cement  
of the nation, just as the land  
is the material cement.”

David Ben-Gurion

In a few years the *Minve*\*, the new home of the Academy of the Hebrew Language, will grace Jerusalem's National Quarter. The *Minve* will be a home and symbol of the Hebrew language, its sounds that resonate around the world and through the ages, and the rich culture that emanates from it.

The Academy is a leader in researching and cultivating the Hebrew language. It has amassed a vast body of knowledge and developed a coherent position on matters of Hebrew. Its status as a state institution enables it to execute large-scale, long-range projects.

Upon the establishment of the *Minve*, the Academy will broaden the nature and extent of its activities, bringing to full fruition its national and state mission: it will found new research institutes, establish a national museum of Hebrew, offer new educational programs, and hold cultural events, while continuing to develop and expand its existing projects, including the Historical Dictionary Project and the Hebrew clearinghouse (an online information center).

The Academy is working to advance the establishment of the *Minve*, a national endeavor proceeding in collaboration with government ministries and with the support of the Government of Israel and the Jerusalem Municipality.

\* All the architectural renderings in this booklet are from the submission that won the public competition for the design of the *Minve*.

\* *minve* (מִינְוֵה, pronounced “meen-VE”) is a new Hebrew word derived from *nave* (נָוֵה, “na-VE”); the latter means ‘home, abode’ and also ‘beautiful, pleasant.’



## THE GOVERNMENT DECISION TO ESTABLISH A “HOME FOR THE HEBREW LANGUAGE IN JERUSALEM”

The Government of Israel responded to the challenges facing the Academy of the Hebrew Language and decided at its meeting on 4 Kislev 5773, November 18, 2012, to establish a new home for the Academy.

The explanatory memorandum to the decision states:

The revival of Hebrew as a spoken language is one of the most eminent achievements in the revival of the People of Israel in its land and a central element in ensuring its national survival. The Government sees national importance in the preservation, development, research, and flourishing of the Hebrew language, as it is a central, fundamental component of Israel's national and cultural identity.

In recognition of the importance of the Hebrew language to the sustenance of the Jewish heritage, to the Zionist enterprise, and to the renaissance of Israel, and in order to heighten the work of the Academy of the Hebrew Language, which by law is charged with imparting the Hebrew language to the public and with cultivating it, the Government resolves to promote the establishment of the home of the Hebrew language in Jerusalem, which will unite under one roof the museum of the Hebrew language and the home of the Academy of the Hebrew Language.

The new home will enable the Academy to develop and augment extensive, vibrant work in its two main pursuits: its academic/research branch and its public[-facing] branch.

In keeping with the government decision, the Academy is advancing the project to build its new home, the *Minve* of the Academy of the Hebrew Language.





## A HOME IN THE HEART OF THE NATIONAL QUARTER

The *Minve* will be located in the heart of Jerusalem's National Quarter, surrounded by institutions of government, culture, science, and higher education – the Academy's peers. Its closest neighbors will include the Knesset, the Israel Museum, the Hebrew University, and the National Library. This area, which already attracts thousands of visitors daily, is in the midst of a surge of development and will soon become even more of a magnet to locals and tourists alike.

The design of the *Minve*, renderings of which adorn this brochure, embraces and integrates nicely into the natural environment of the site in an aesthetically pleasing way, while fitting in well with the development plans for the area and its future bustle of activity. The design stands out for its focus on the people who will interact with the site, creating an inviting and open structure that gives a feeling of space. These values of localism and openness guided the selection of the winning design, submitted by Mayslits Kassif Roytman Architects, from among the 100 entries in the public competition.

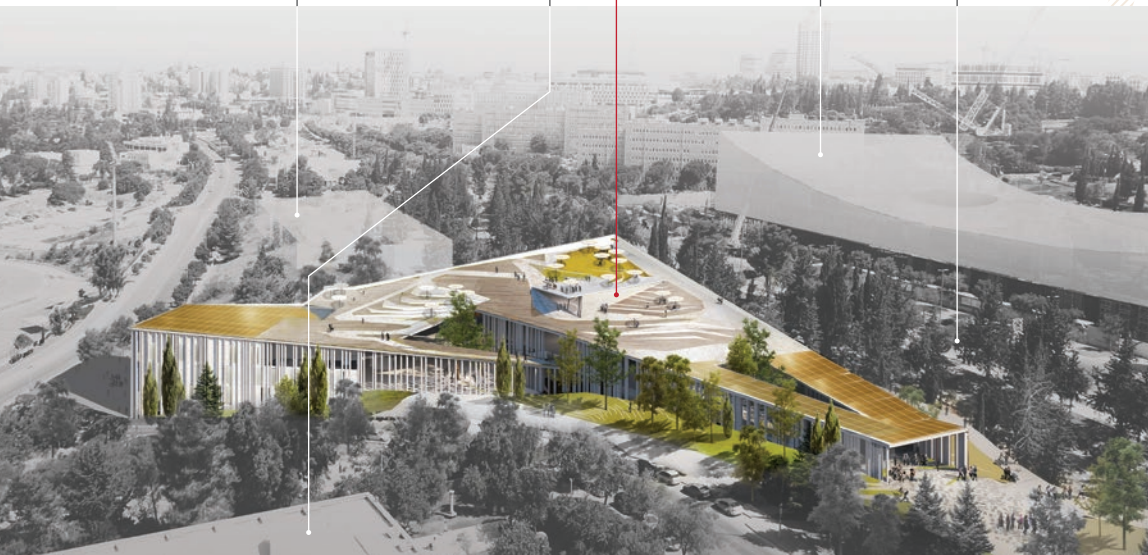



## HEBREW RESEARCH AND INTERACTION WITH THE PUBLIC UNDER ONE ROOF

Since its founding, the Academy has progressively built its standing as a center for Hebrew research. In the last decade, in tandem with its academic work, the Academy has expanded and brought to the fore its work with the public, in order to connect Hebrew speakers to their language and culture and to Hebrew's richness and vitality. This work has blossomed into an extensive body of activity based on interaction with the public through the internet, social media, and other means.

The *Minve* will house all of the Academy's departments and activities – those of the research arm and the public-facing arm alike – and will incorporate two major new units for the public: a museum of Hebrew and a center for cultural and educational activities. Drawing upon the Academy's wealth of academic knowledge, these two units will introduce visitors to engaging and intriguing aspects of human language in general and of Hebrew in particular. Their power to attract the public will stem from the Academy's authority on all matters Hebrew, its reputation of academic excellence, and its high public esteem.





## A. GUIDING THE DEVELOPMENT OF HEBREW AND RESEARCHING THE LANGUAGE

### Guiding the development of Hebrew

It is the Academy's legally mandated role to guide the development of Hebrew on the basis of research spanning all periods and branches of the language. The members of the Academy participate in standing committees that address issues of grammar and review proposed Hebrew terms, as well as discipline-specific terminology committees that prepare professional dictionaries in all fields of study and activity. The committees submit their proposals to the plenum of the Academy for approval.

### The Historical Dictionary Project

The Historical Dictionary Project is a national undertaking whose ultimate purpose is to compile an academically rigorous historical dictionary that will be the most authoritative Hebrew dictionary encompassing all periods of the Hebrew language.

To illuminate the evolution of words' usage, the Dictionary Project's researchers spent decades documenting and analyzing almost every extant Hebrew work written from the Biblical period to the 11th century and are now busy processing a large selection of works from the last millennium, up to the 20th century. The digitized and analyzed texts are available to the public on the *Ma'agarim* website in the form of a massive concordance – effectively, an archive of Hebrew vocabulary and composition over the ages.

In the coming years the Academy aims to extend the scope of the Dictionary Project to include contemporary (“Israeli”) Hebrew and to install the team of scholars that will write the dictionary entries.

### New research institutes

At the *Minve* the Academy plans to found research institutes for the study of Hebrew lexicography, Israeli Hebrew, and the revival of the Hebrew language. These institutes will be home to leading scholars in the respective fields and will host visiting scholars from Israel and abroad.

### The Academy's archive

The Academy's archive contains records of the work of both the Academy (since its inception) and its predecessor, the Language Committee, as well as the personal archives of a number of important Hebrew scholars. Additional material will enrich the archive further, eventually turning it into a national repository for the history of Hebrew's revival and gradual entrenchment as the living tongue of the Jewish people and of the state.

### Audio archive

The Academy's holdings also include the collection of the Center for the Study of the Traditions of the Communities of Israel established by Prof. Shlomo Morag at the Hebrew University. The collection contains audio recordings of the reading of the Bible, Mishna, liturgy, and other texts by over 300 informants from about 30 countries, representing traditions of both Eastern and Western communities. A dedicated website provides public access to these rare recordings.

In addition the Academy holds the Zipporah and Aaron Bar-Adon Collection on the History of the Revival of the Hebrew Language. This collection, too, will be available to the public.





## B. MAKING THE INFORMATION ACCESSIBLE

### An online Hebrew information clearinghouse

The Academy's website provides the public with an unparalleled information clearinghouse on the Hebrew word that draws information from all of the Academy's databases. The clearinghouse revolves around the Hebrew "entry" – a word or phrase – and retrieves the entry's standard spelling, dictionary definition, and grammatical information (including conjugation or declension); the entry's frequency of usage over the centuries (with a link to citations); Academy-approved professional terms in which the entry occurs; Academy decisions regarding the entry; and an abundance of other informative content relating to it, drawn from among the many articles and essays posted on the website.

The Academy's website is a source of reliable, authoritative information that serves tens of thousands of users daily. The Academy aims to expand and enhance its databases and the online services it provides to the general public.

### Direct contact with the public

The Academy reaches out to the public and shares information on Hebrew through a variety of channels with a very substantial combined audience: tens of thousands of Hebrew enthusiasts subscribe to the Academy's newsletter; hundreds of thousands of all ages follow the Academy's accounts on social networks (Facebook, Instagram, Twitter, and TikTok); and special projects in collaboration with media outlets reach a broad swath of the population. In addition, Academy employees diligently compose professional responses to the thousands of Hebrew queries that arrive every month.

The Academy is constantly expanding this work and aspires to reach additional audiences in Israel and abroad and also to deepen its connection with the public through the cultural and educational center and the museum that will be built at the *Minve*.





### A cultural and educational center

Special events and customized programs for visitors will fall under the purview of the cultural and educational center, whose facilities will include classrooms and an auditorium. The *Minve* will provide the Academy with ample space to offer a wealth of educational and cultural programs and host academic conferences comfortably on-site.

**Educational programs for groups:** The cultural and educational center will offer state-of-the-art experiential learning and enrichment programs to organized groups of teenagers and adults. The programs will introduce participants to thought-provoking questions about Hebrew and its place in their daily lives and in their cultural life through a pleasurable investigative experience.

**A home for teachers:** The Academy aspires to be a home for teachers of Hebrew language and culture, developing for them on-site and online continuing-education courses with specialized curricula.

**Continuing education and seminars:** The Academy already offers accredited continuing-education programs, as well as seminars and lectures on select topics in Hebrew language, for professionals and interested members of the general public; the programs draw their instructors from the ranks of the Academy's experts. The move to the *Minve* will enable the Academy to increase these offerings.

**Cultural events:** At the *Minve* the Academy will regularly hold cultural events open to the public, centered upon Hebrew and its cultural significance and featuring short lectures, panel discussions, and performances by artists. The Academy's annual events marking Hebrew Day will be held all over the grounds of the *Minve* with a multitude of participants.

**Academic conferences:** The Academy hosts annual academic conferences attended by leading Hebrew scholars from Israel and abroad. These conferences reflect the Academy's standing as a top-notch Hebrew-language research institute.





## C. THE MUSEUM OF THE HEBREW LANGUAGE

### **Hebrew: a story of continuity and innovation**

Hebrew is the train carrying the freight of Jewish history and Hebrew culture from station to station along the nation's journey through time. It is the language of Israelis and Jews all over the world; it is an ancient language and a new language, the language of the liturgy and the language of science, the language of children and the language of writers and poets. From time immemorial Hebrew has accompanied people through the stages of their lives and has told a story of continuity and innovation, of tradition and change.

The Museum of the Hebrew Language will tell chapters of this story. The Academy will establish the museum – the first of its kind – and through it present for the first time a visual, auditory, and experiential picture of Hebrew, with all its component fields and associated disciplines, a picture based on the firm foundation of academic research.





### The visitor's experience at the museum

Visitors to the museum will enjoy an in-depth, original look at Hebrew in a broad cultural context and gain acquaintance with varieties of Hebrew in different periods and locations, contemporary Hebrew, and general aspects of language.

The museum's content will inspire a sense of identification and pride among Hebrew speakers and connect the non-Hebrew-speaking audience to the unique story of Hebrew. The museum will exemplify the interplay between the academic study of the language and the linguistic reality in which it occurs, both through the exhibits themselves and through the museum's interaction with its physical and sociocultural environment. The museum will afford visitors an experience of attention, contemplation, creation, and play, and its fresh examination of the Hebrew language in all its richness and attendant issues will stimulate curiosity and wonder.

The museum experience will extend to the outdoor areas of the *Minve* through a variety of exhibits, such as captivating installations in the portico leading to the entrance hall of the museum and on the rooftop promenade; an "audio lookout" presenting the multiplicity of languages found in the diverse communities of Jerusalem; and a nighttime display under the stars.





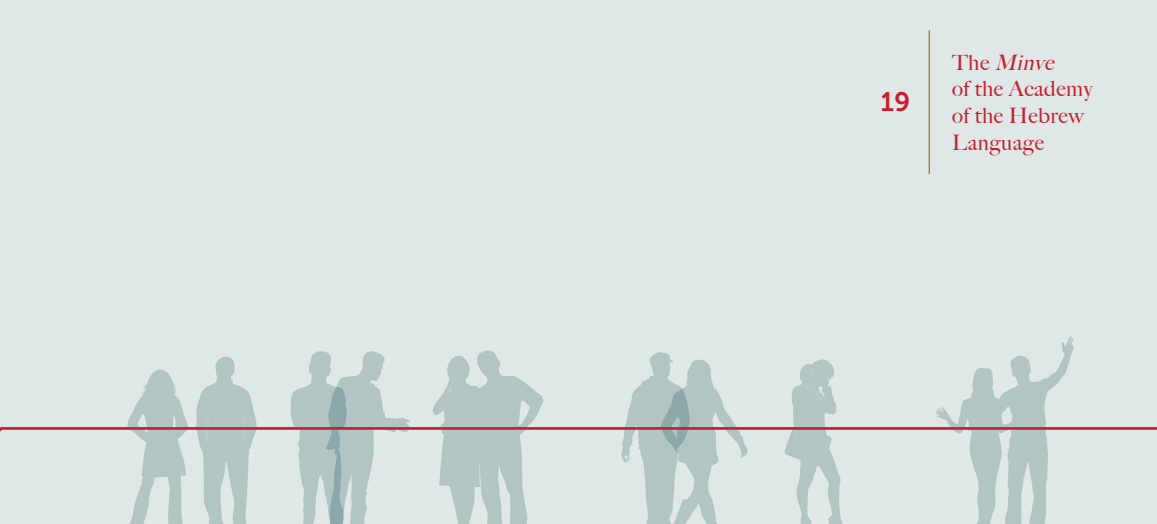

## ALLOCATION OF SPACE

	Net area (m <sup>2</sup> )	Gross area (m <sup>2</sup> )
Public areas	~2,500	~3,700
Shared areas	~1,200	~1,800
Staff areas	~1,900	~3,500
<b>Total</b>	<b>~5,600</b>	<b>~9,000</b>
Underground areas: parking and operations		~5,200
Covered outdoor areas		~1,600
Active roof and additional outdoor areas		~3,400

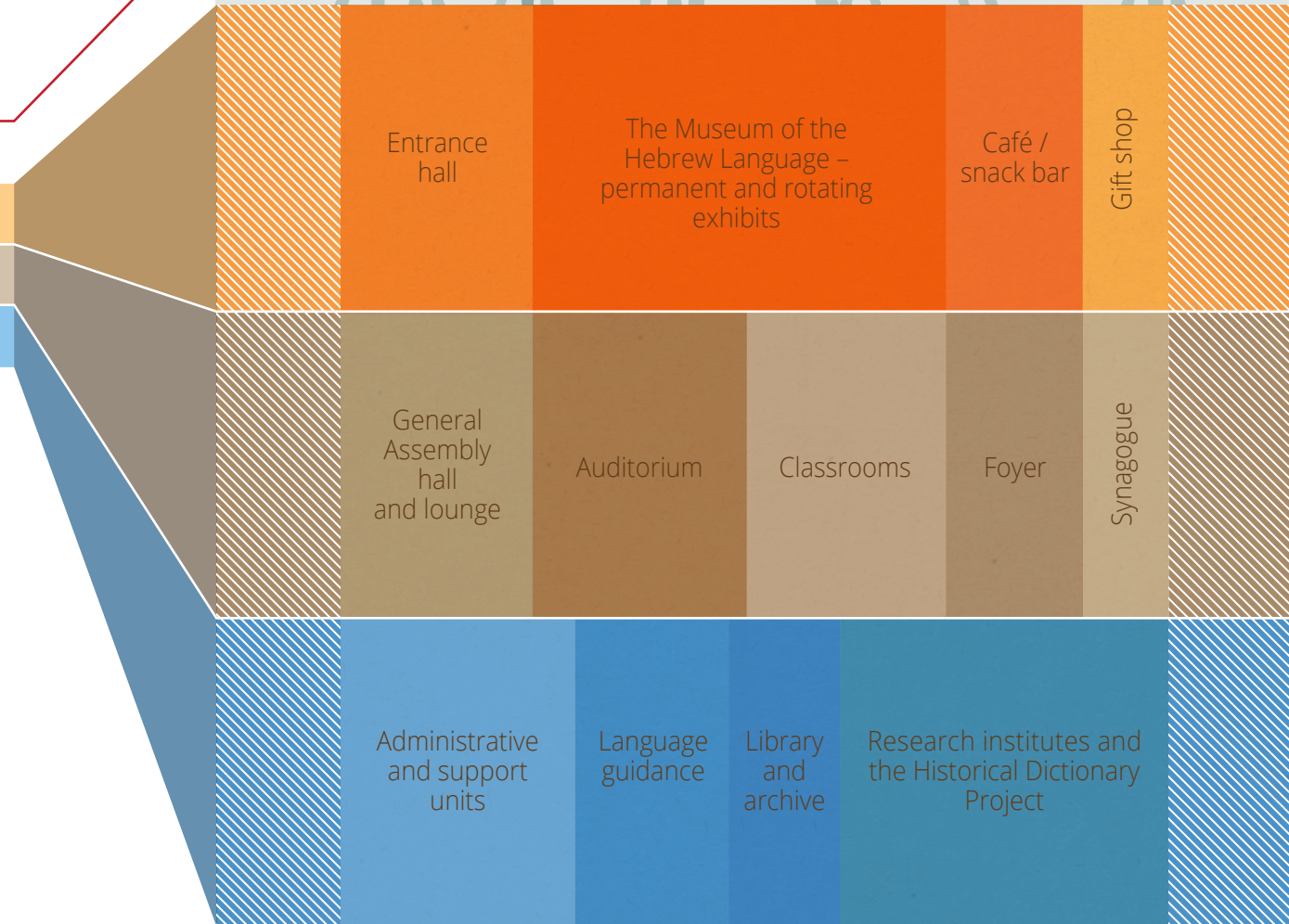

**Project budget (preliminary estimate): \$100 million**

## CONCLUDING THOUGHTS

Establishing the *Minve* will enable the Academy to realize in full its national and state mission and to tell the story of Hebrew – a story of tradition and renewal and of the vitality of an ancient language in a new reality.

By means of language, and through it, the cultural heritage of a nation passes from generation to generation. The words – they are what carry in them, from father to son, the nation's qualities and marks of character, its cumulative experience – like genes in wheat seed or in human seed. You utter a word, a sentence, and they echo from one end to the other of your nation's chronicles from the distant past to the present day. You say רוח (*ruah*) in Hebrew, which means 'wind,' and 'spirit,' and 'ghost,' and 'god' – and רוחות (*ruhot*, plural of *ruah*) from all ages come to you: from the days of Creation, when the *ruah* of God was hovering upon the surface of the waters, to the hot *ruhot* that blow today in the expanses of the Negev (Aharon Meged, "Cultural Heritage and Language," *Davar*, 6 Tevet 5735, December 20, 1974).

We look forward to the continued partnership of generous philanthropists and funders as we complete the *Minve* of the Academy of the Hebrew Language in Jerusalem in the coming years.

**Join us!**



**האקדמיה ללשון העברית**  
**The Academy of the Hebrew Language**

Giv'at Ram Campus, Jerusalem 9190401, Israel

E-mail: [ivrit@hebrew-academy.org.il](mailto:ivrit@hebrew-academy.org.il)

Phone: +972-2-649-3555 | Fax: +972-2-561-7065

Website: [hebrew-academy.org.il](http://hebrew-academy.org.il)